

**NOTICE OF ONLINE PUBLIC INFORMATION CENTRE #2 FOR STUDY #2 (GWP 4010-21-00)
Preliminary Design and Environmental Assessment for Highway 401 from County Road 28
(Ontario Street) to Hamilton Road, Port Hope**

BACKGROUND

The Ministry of Transportation (MTO) retained the services of Egis and LEA Consulting Ltd. Joint Venture (Egis-LEA Joint Venture) to carry out the Preliminary Design and Class Environmental Assessment (Class EA) for Highway 401 from 500m west of Cranberry Road to 450m east of County Road 28, including the Cranberry Road bridge, Choate Road bridge, Ganaraska River bridge, Hamilton Road bridge and County Road 28 (Ontario Street) Interchange in Port Hope. The initial study has been divided into two separate studies.

STUDY # 1 GWP 4005-17-00 included structural needs of 3 bridges (Cranberry Road Bridge, Choate Road Bridge and Ganaraska River Bridge) and establishing the eight (8) and ten (10) lane future footprint of Highway 401 from 500m west of Cranberry Road to 450m east of County Road 28 (Ontario Street). Preliminary Design was completed and environmental clearance was issued in 2022.

STUDY #2 GWP 4010-21-00 includes future operational long-term needs at the County Road 28 (Ontario Street) interchange, and structural needs of 2 bridges (County Road 28 Bridge and Hamilton Road Bridge).

The purpose of this notice is to invite interested stakeholders to participate in the second online Public Information Centre (PIC) for Study #2 (GWP 4010-21-00).

ONLINE PUBLIC INFORMATION CENTRE

The purpose of the second PIC for Study #2 (GWP 4010-21-00) is to present the study process, recommended plan, and receive input on the proposed improvements within the study area. The online PIC will be available for a 30-day review and comment period from **October 25, 2024- November 25, 2024.**

To view the PIC materials and provide comments, please visit **www.Hwy401PortHopeEA.com**. Under the Public Involvement tab for Study #2 (GWP 4010-21-00), click the link for Online Public Information Centre #2. Hard copies of the PIC materials are also available upon request.

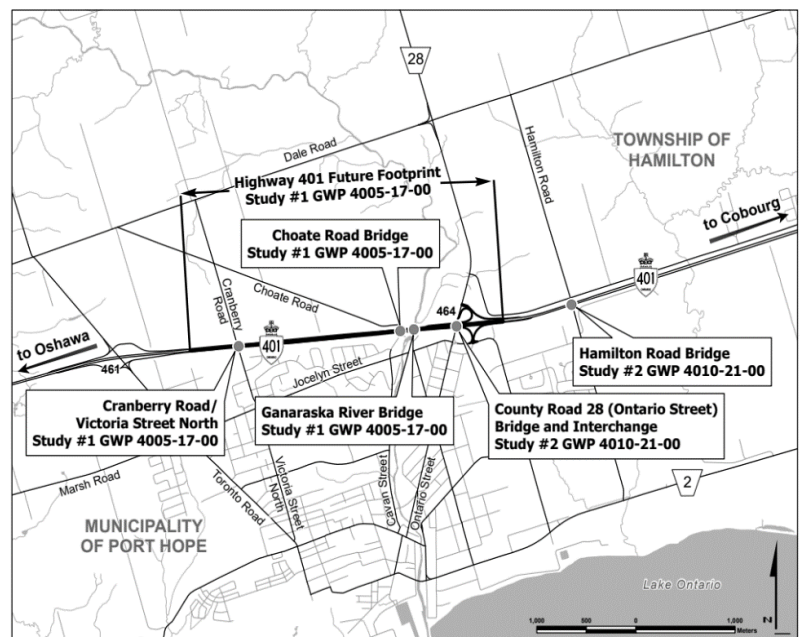

THE PROCESS

The Preliminary Design is following the approved planning process for a Group 'B' project under the *Class Environmental Assessment (EA) for Provincial Transportation Facilities (2000)*. Upon completion of the preliminary design, a Transportation Environmental Study Report (TESR) will be prepared and made available for 30-day public comment period. Notices will be published in local newspapers, posted on the project website, and sent to the project mailing list to advise the public of the TESR public comment period. The TESR will document the existing conditions of the study area, the evaluation of the alternatives, and identify the recommended plan and commitments to future work.

COMMENTS

All comments received during this period will be reviewed by the project team following the conclusion of the online PIC, and if requested a response will be provided. Comments will be received through the website or can be submitted to the contacts below.

If you would like your name added to the project mailing list, please contact one of the project members or submit a comment through the project website.

Ms. Laura Donaldson, P.Eng.

Project Manager
McIntosh Perry Consulting Engineers Ltd.
1-1329 Gardiners Road
Kingston, ON K7P 0L8
Tel: 613-343-2635 or
Email: l.donaldson@mcintoshperry.com

Mr. Chris Teepell

MTO Senior Project Manager
Ministry of Transportation – Project Delivery East
1355 John Counter Boulevard, Postal Bag 4000
Kingston, ON K7L 5A3
Tel: 613-583-3109 or
Email: Chris.Teepell@Ontario.ca

Comments are being collected to assist MTO in meeting the requirements of the Ontario Environmental Assessment Act. All information/comments received will be maintained on file for use during the study and may be included in the study documentation. With the exception of personal information, all comments will become part of the public record in accordance with the *Freedom of Information and Protection of Privacy Act*. If you have accessibility requirements in order to participate in this project, please contact one of the project team members listed above.